

SURVEYOR'S OFFICE
Hamilton County

Kenton C. Ward, CFM
Surveyor of Hamilton County
Phone (317) 776-8495
Fax (317) 776-9628

Suite 188
One Hamilton County Square
Noblesville, Indiana 46060-2230

July 24, 2008

To: Hamilton County Drainage Board

Re: McMahan-Overdorf Drain, SMC Arm

Attached is a 52.0 petition and plans for the proposed relocation of the McMahan-Overdorf Drain, SMC Arm. The relocation is being proposed by the City of Noblesville. The proposal is to relocate the drain across parcel #11-11-18-00-00-011.009 owned by Noblesville Park Partner, LLC and Cumberland Road right-of-way owned by the City of Noblesville as part of the SMC Public Infrastructure project per plans by American Structurepoint, Job No. IN2007.1408 revision date May 8, 2008.

Per the plans, drainage will be routed from proposed Structure 100A of the above referenced plans to an existing manhole, Structure 107 as shown on sheet C2.1 of the plans for Noblesville Business Park prepared by American Consulting Engineers, Job No. IN2002-0952 dated January 2, 2003, last revision date March 15, 2004. The drain was previously noted as Arm 1 in my Surveyor's report dated February 10, 2003 approved on March 24, 2003 as recorded in Minutes Book 7 Pages 5-8. Said manhole is located at the northwest corner of 150th Street and Cumberland Road located within Noblesville Business Park.

This line will consist of the following:

36" RCP 155 ft.

The total length of the new drain shall be 155 feet. The 100 feet of original drain between Station 0 and 1+00 shall be vacated. This is Arm 1 of the 1882 J.R. Christian Drain which became the main drain of the McMahan-Overdorf Drain in 1912. This proposal will add 55 feet to the drain's total length.

The cost of the relocation is to be paid by the City of Noblesville.

This project will change the drainage shed to include the following entire parcels:

Parcel #10-11-17-00-00-014.000 owned by SMC Corporation.

Parcel #10-11-17-00-00-013.000 owned by SMC Corporation.

Parcel #10-11-17-00-00-011.001 owned by Meritex Noblesville LLC

Parcel #10-11-17-00-00-011.000 owned by Falcon Properties III LLC

Howe Road right of way owned by the City of Noblesville.

This shed change is per plan sheet titled "Offsite Drainage Basins to SMC Boulevard"
(Ex 1).

The project falls under the requirements as set out in IC 36-9-27-52.0. Therefore, a hearing request is required for the petition. I recommend that the Board set a hearing date for August 25, 2008.

Sincerely,

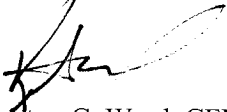

Kenton C. Ward, CFM
Hamilton County Surveyor

KCW/pll

HAMILTON COUNTY DRAINAGE BOARD
NOBLESVILLE, INDIANA

IN RE: _____)
Hamilton County, Indiana)

PETITION FOR RELOCATION AND RECONSTRUCTION

_____ City of Noblesville (hereinafter "Petitioner"),
hereby petitions the Hamilton County Drainage Board for authority to relocate and improve a
section of the _____ McMahan-Overdorf Drain, and in support of
said petition advises the Board that:

1. Petitioner owns real estate through which a portion of the _____ McMahan-Overdorf Drain runs.
2. Petitioner plans to develop its real estate with roads, buildings, utilities, storm drains, sanitary sewers and other structures.
3. Petitioner's proposed development of its real estate will require relocation and reconstruction of a portion of the _____ McMahan-Overdorf Drain, as specifically shown on engineering plans and specifications filed with the Hamilton County Surveyor.
4. The work necessary for the proposed relocation and reconstruction will be undertaken at the sole expense of the Petitioner and such work will result in substantial improvement to the _____ McMahan-Overdorf Drain, without cost to other property owners on the watershed of the _____ McMahan-Overdorf Drain.

WHEREFORE, Petitioner requests that an Order issued from the Hamilton County Drainage Board authorizing relocation and reconstruction of the _____ McMahan-Overdorf Drain, in conformance with applicable law and plans and specifications on file with the Hamilton County Surveyor.

John Beery 5/21/08
Signed
Mr. John Beery, P.E., Noblesville City Engineer
Printed

FINDINGS AND ORDER
CONCERNING THE MAINTENANCE OF THE
McMahon-Overdorf Drain, SMC Arm

On this **25th day of August 2008**, the Hamilton County Drainage Board has held a hearing on the Maintenance Report and Schedule of Assessments of the **McMahon-Overdorf Drain, SMC Arm**.

Evidence has been heard. Objections were presented and considered. The Board then adopted the original/amended Schedule of Assessments. The Board now finds that the annual maintenance assessment will be less than the benefits to the landowners and issues this order declaring that this Maintenance Fund be established.

HAMILTON COUNTY DRAINAGE BOARD

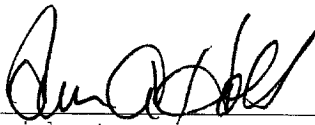

President

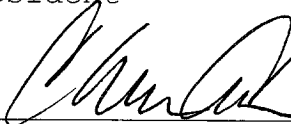

Member

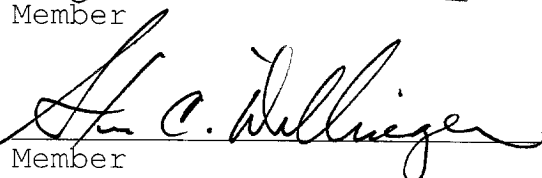

Member

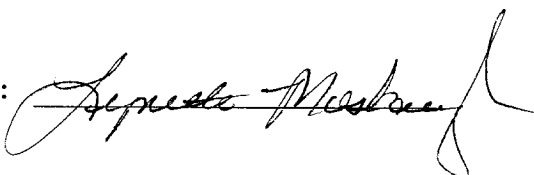
Attest: 

FINDINGS AND ORDER
CONCERNING THE MAINTENANCE OF THE
Oliver Shoemaker Drain

On this **25th day of August 2008**, the Hamilton County Drainage Board has held a hearing on the Maintenance Report and Schedule of Assessments of the **Oliver Shoemaker Drain**.

Evidence has been heard. Objections were presented and considered. The Board then adopted the original/amended Schedule of Assessments. The Board now finds that the annual maintenance assessment will be less than the benefits to the landowners and issues this order declaring that this Maintenance Fund be established.

HAMILTON COUNTY DRAINAGE BOARD

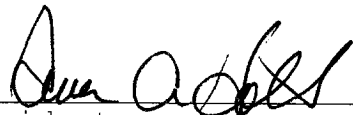

President



Member

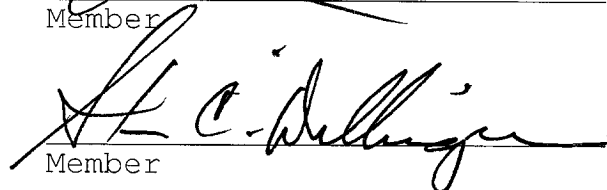

Member

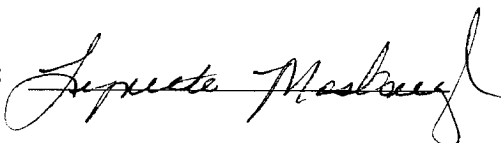
Attest: 

FINDINGS AND ORDER
CONCERNING THE MAINTENANCE OF THE
Wheeler & Wheeler Drain

On this **25th day of August 2008**, the Hamilton County Drainage Board has held a hearing on the Maintenance Report and Schedule of Assessments of the **Wheeler & Wheeler Drain**.

Evidence has been heard. Objections were presented and considered. The Board then adopted the original/amended Schedule of Assessments. The Board now finds that the annual maintenance assessment will be less than the benefits to the landowners and issues this order declaring that this Maintenance Fund be established.

HAMILTON COUNTY DRAINAGE BOARD

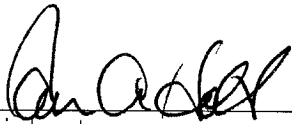

President



Member

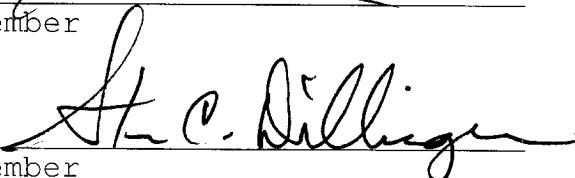

Member

Attest: 

FINDINGS AND ORDER

CONCERNING THE PARTIAL VACATION OF THE

**McMahon-Overdorf Drain, SMC Arm
Sta. 0 to Sta.1+00**

On this *25th day of August 2008*, the Hamilton County Drainage Board has held a hearing on the Maintenance Report and Schedule of Assessments of the **McMahon-Overdorf Drain, SMC Arm, Sta. 0 to Sta. 1+00**.

Evidence has been heard. Objections were presented and considered. The Board then adopted an order of action. The Board now finds that the costs of continued maintenance to the portion of the above drain exceed the benefits to the real estate benefited by the portion of the drain to be abandoned and issues this order vacating the above section of the **McMahon-Overdorf Drain, SMC Arm**.

HAMILTON COUNTY DRAINAGE BOARD



President

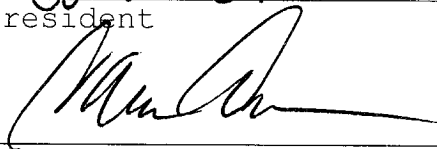

Member

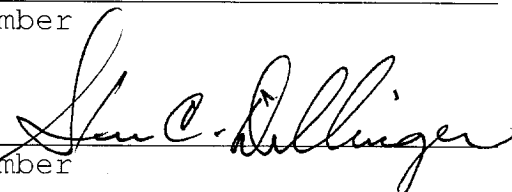

Member

Attest:



STATE OF INDIANA)
) ss:
COUNTY OF HAMILTON)

BEFORE THE HAMILTON COUNTY
DRAINAGE BOARD
NOBLESVILLE, INDIANA

IN THE MATTER OF THE
RECONSTRUCTION OF THE
McMahan-Overdorf Drain, SMC Arm

FINDINGS AND ORDER FOR RECONSTRUCTION

The matter of the proposed Reconstruction of the *McMahan-Overdorf Drain, SMC Arm* came before the Hamilton County Drainage Board for hearing *on August 25, 2008*, on the Reconstruction Report consisting of the report and the Schedule of Damages and Assessments. The Board also received and considered the written objection of an owner of certain lands affected by the proposed Reconstruction, said owner being:

Evidence was heard on the Reconstruction Report and on the aforementioned objections.

The Board, having considered the evidence and objections, and, upon motion duly made, seconded and unanimously carried, did find and determine that the costs, damages and expenses of the proposed Reconstruction will be less than the benefits accruing to the owners of all land benefited by the Reconstruction.

The Board having considered the evidence and objections, upon motion duly made, seconded and unanimously carried, did adopt the Schedule of Assessments as proposed, subject to amendment after inspection of the subject drain as it relates to the lands of any owners which may have been erroneously included or omitted from the Schedule of Assessments.

The Board further finds that it has jurisdiction of these proceedings and that all required notices have been duly given or published as required by law.

Wherefore, it is ORDERED, that the proposed Reconstruction of the *McMahon-Overdorf Drain, SMC Arm* be and is hereby declared established.

Thereafter, the Board made inspection for the purpose of determining whether or not the lands of any owners had been erroneously included or excluded from the Schedule of Assessments. The Board finds on the basis of the reports and findings at this hearing as follows:

HAMILTON COUNTY DRAINAGE BOARD

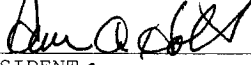

PRESIDENT



Member



Member

ATTEST:

Executive Secretary

BEFORE THE HAMILTON COUNTY DRAINAGE BOARD
IN THE MATTER OF

McMahon-Overdorf Drain, SMC Arm

NOTICE

To Whom It May Concern and: _____

Notice is hereby given of the hearing of the Hamilton County Drainage Board concerning the reconstruction of the **McMahon-Overdorf Drain, SMC Arm** on **August 25, 2008**, at **9:05 A.M.** in Commissioners Court, Hamilton County Judicial Center, One Hamilton County Square, Noblesville, Indiana. Construction and maintenance reports of the Surveyor and the Schedule of Assessments proposed by the Drainage Board have been filed and are available for public inspection in the office of the Hamilton County Surveyor.

Hamilton County Drainage Board

Attest: Lynette Mosbaugh

ONE TIME ONLY

STATE OF INDIANA)
) SS BEFORE THE HAMILTON
)
COUNTY OF HAMILTON) DRAINAGE BOARD

IN THE MATTER OF **McMahon-Overdorf Drain, SMC Arm**

NOTICE

Notice is hereby given that the Hamilton County Drainage Board at its regular meeting **August 25, 2008** adopted the reconstruction report of the Surveyor and the Amended Schedule of damages and assessments including annual assessment for periodic maintenance, finding that the costs, damages and expense of the proposed improvement would be less than the benefits which will result to the owner of lands benefited thereby.

The Board issued an order declaring the proposed improvement established. Such findings and order were marked filed and are available for inspection in the Office of the Hamilton County Surveyor.

If judicial review of the findings and order of the Board is not requested pursuant to Article VIII of the 1965 Indiana Drainage Code as amended within twenty (20) days from the date of publication of this notice, the findings and order shall become conclusive.

HAMILTON COUNTY DRAINAGE BOARD

BY: Steven A. Holt
PRESIDENT

ATTEST: Lynette Mosbaugh
SECRETARY



Kenton C. Ward, CFM
Surveyor of Hamilton County
Phone (317) 776-8495
Fax (317) 776-9628

Suite 188
One Hamilton County Square
Noblesville, Indiana 46060-2230

To: Hamilton County Drainage Board

September 7, 2011

Re: McMahan- Overdorf Drain: SMC Arm

Attached are as-builts, certificate of completion & compliance, and other information for SMC Arm. An inspection of the drainage facilities for this section has been made and the facilities were found to be complete and acceptable.

During construction, changes there were no significant changes made to the drainage plans submitted with my report for this drain dated July 24, 2008. The report was approved by the Board at the hearing held August 25, 2008. (See Drainage Board Minutes Book 11, Pages 280-284) Therefore, the length of the drain remains at **155 feet**. It should be noted that the project removed Str. 105, 102 and 47 feet of 36" from the Noblesville Business Park Arm to the McMahan-Overdorf Drain. Also removed was the original tile between Sta. 0 to Sta. 1+00 of the JR Christian Arm 1 to the McMahan-Overdorf Drain. Therefore, 8 feet of drain was added to the overall watershed length.

A non-enforcement was not required for this project. The project was paid for by the City of Noblesville and sureties were not required.

I recommend the Board approve the drain's construction as complete and acceptable.

Sincerely,

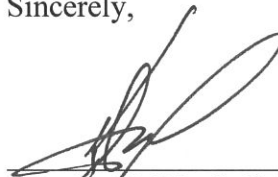

Kenton C. Ward, CFM
Hamilton County Surveyor

KCW/slm

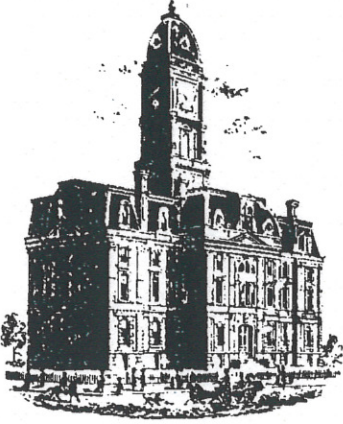

SURVEYOR'S OFFICE

Hamilton County

Kenton C. Ward, CFM
 Surveyor of Hamilton County
 Phone (317) 776-8495
 Fax (317) 776-9628

Suite 188
 One Hamilton County Square
 Noblesville, Indiana 46060-2230

July 24, 2008

To: Hamilton County Drainage Board

Re: McMahan-Overdorf Drain, SMC Arm

Attached is a 52.0 petition and plans for the proposed relocation of the McMahan-Overdorf Drain, SMC Arm. The relocation is being proposed by the City of Noblesville. The proposal is to relocate the drain across parcel #11-11-18-00-00-011.009 owned by Noblesville Park Partner, LLC and Cumberland Road right-of-way owned by the City of Noblesville as part of the SMC Public Infrastructure project per plans by American Structurepoint, Job No. IN2007.1408 revision date May 8, 2008.

Per the plans, drainage will be routed from proposed Structure 100A of the above referenced plans to an existing manhole, Structure 107 as shown on sheet C2.1 of the plans for Noblesville Business Park prepared by American Consulting Engineers, Job No. IN2002-0952 dated January 2, 2003, last revision date March 15, 2004. The drain was previously noted as Arm 1 in my Surveyor's report dated February 10, 2003 approved on March 24, 2003 as recorded in Minutes Book 7 Pages 5-8. Said manhole is located at the northwest corner of 150th Street and Cumberland Road located within Noblesville Business Park.

This line will consist of the following:

36" RCP 155 ft.

The total length of the new drain shall be 155 feet. The 100 feet of original drain between Station 0 and 1+00 shall be vacated. This is Arm 1 of the 1882 J.R. Christian Drain which became the main drain of the McMahan-Overdorf Drain in 1912. This proposal will add 55 feet to the drain's total length.

The cost of the relocation is to be paid by the City of Noblesville.

Removed From NBP Recon (2004)

Removed
 * 2 Rows of 7" Tile - 100'

23 of 36" RCP @ Str. 105

24 36" RCP @ Str. 102

This project will change the drainage shed to include the following entire parcels:

Parcel #10-11-17-00-00-014.000 owned by SMC Corporation.

Parcel #10-11-17-00-00-013.000 owned by SMC Corporation.

Parcel #10-11-17-00-00-011.001 owned by Meritex Noblesville LLC

Parcel #10-11-17-00-00-011.000 owned by Falcon Properties III LLC

Howe Road right of way owned by the City of Noblesville.

This shed change is per plan sheet titled "Offsite Drainage Basins to SMC Boulevard"
(Ex 1).

The project falls under the requirements as set out in IC 36-9-27-52.0. Therefore, a hearing request is required for the petition. I recommend that the Board set a hearing date for August 25, 2008.

Sincerely,



Kenton C. Ward, CFM
Hamilton County Surveyor

KCW/pll

FINDINGS AND ORDER

CONCERNING THE PARTIAL VACATION OF THE

**McMahon-Overdorf Drain, SMC Arm
Sta. 0 to Sta.1+00**

On this **25th day of August 2008**, the Hamilton County Drainage Board has held a hearing on the Maintenance Report and Schedule of Assessments of the **McMahon-Overdorf Drain, SMC Arm, Sta. 0 to Sta. 1+00**.

Evidence has been heard. Objections were presented and considered. The Board then adopted an order of action. The Board now finds that the costs of continued maintenance to the portion of the above drain exceed the benefits to the real estate benefited by the portion of the drain to be abandoned and issues this order vacating the above section of the **McMahon-Overdorf Drain, SMC Arm**.

HAMILTON COUNTY DRAINAGE BOARD

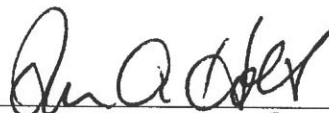

President

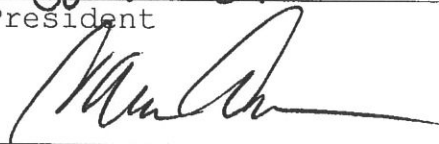

Member

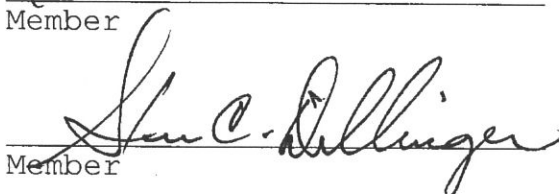

Member

Attest:



Book 11
pg. 280-284

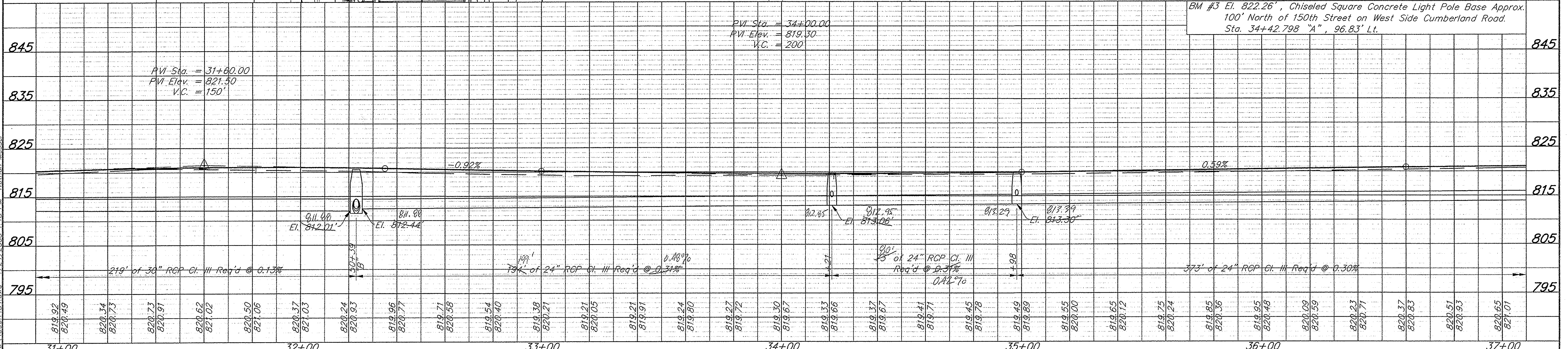
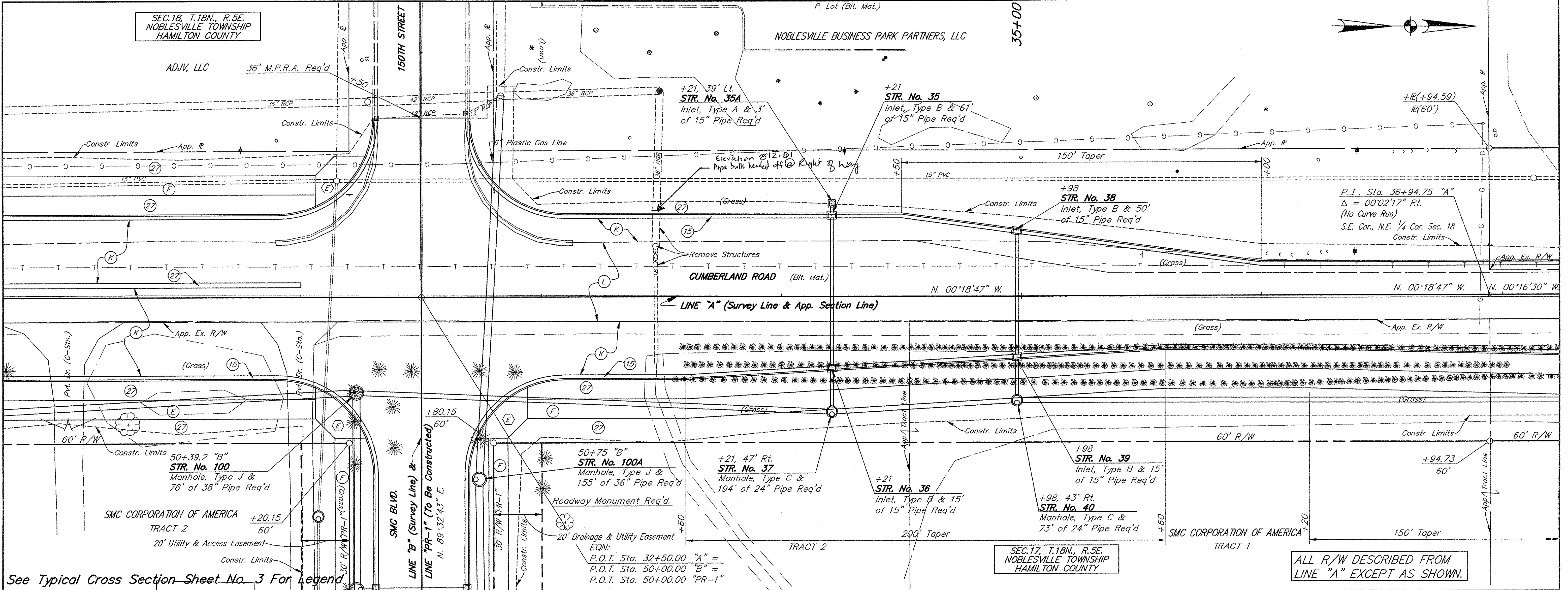

Stop Sign
Cumberland Rd. Line "A"

Sign Post
150th/Cumbr.

Mag Nail in Powerpole

Iron Pin
App. Prop. Car.

Line "A"

Cumberland Rd.

West face
12" dia.
P.O.T. Sta. 50+00.00 "B"

Mag Nail (Set), Flush

EQN:
P.O.T. Sta. 50+00.00 "B"
P.O.T. Sta. 50+00.00 "PR-1"

Hamilton County Surveyor
Noblesville, In 46060

This information was gathered for input into the Hamilton County Geographic Information System (GIS). This document is considered an official record of the GIS.

Entry Date: Sept 2011

Entered By: Gln

GREGORY M. QUINN
REGISTERED
No. 20500019
STATE OF INDIANA
LAND SURVEYOR

As Built
2/5/09

MATTHEW S. JENABEK
REGISTERED
No. 15200008
STATE OF INDIANA
PROFESSIONAL ENGINEER

RECOMMENDED FOR APPROVAL: *Matthew Jenabek* 4/11/08

DESIGN ENGINEER DATE

NOBLESVILLE INDIANA

DESIGNED: MSL DRAWN: NSM

CHECKED: B.Z. CHECKED: MSL

Headquarters: 8450 WESTFIELD BLVD., SUITE 300 INDIANAPOLIS, IN 46240-8302 TEL: 317-713-4615 FAX: 317-713-4616 www.BFSinc.com

Branch Locations:
BLUFFTON 812-295-0590
JEFFERSONVILLE 812-295-0590
MERRILLVILLE 219-789-2333
PLAINFIELD 317-839-3242

PLAN AND PROFILE
LINE "A"

HORIZONTAL SCALE
1" = 20'

VERTICAL SCALE
1" = 10'

SURVEY BOOK
341

CONTRACT
N/A

FILE
4596

DESIGNATION
N/A

SHEET
155

PROJECT
N/A

BFS NO. 4596-0701

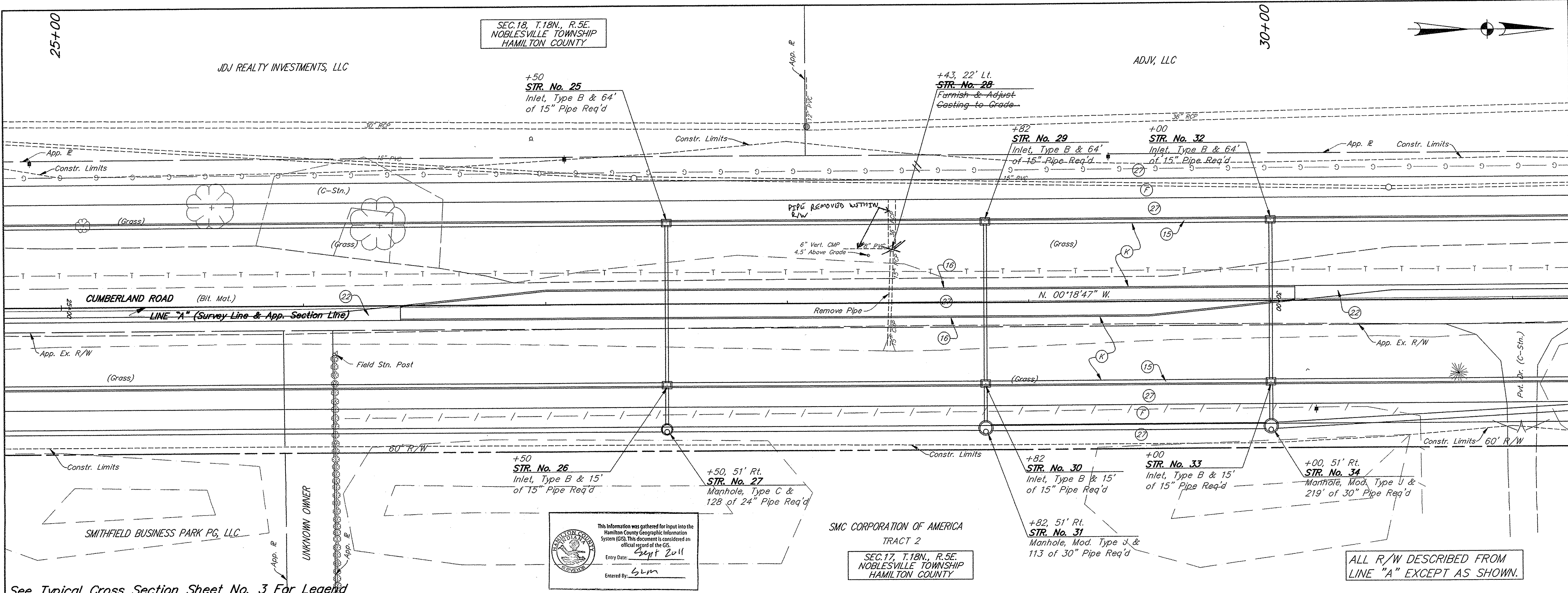

This information was gathered for input into the Hamilton County Geographic Information System (GIS). This document is considered an official record of the GIS.
 Entry Date: Sept 2011
 Entered By: GJM

SMC CORPORATION OF AMERICA
 TRACT 2
 SEC. 17, T. 18N., R. 5E. NOBLESVILLE TOWNSHIP HAMILTON COUNTY

ALL R/W DESCRIBED FROM LINE "A" EXCEPT AS SHOWN.

See Typical Cross Section Sheet No. 3 For Legend

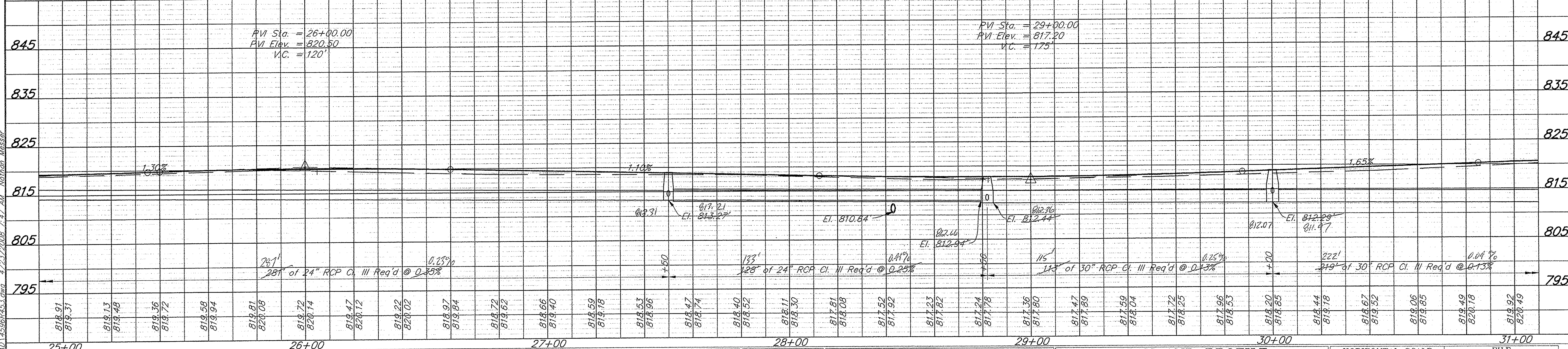

RECOMMENDED FOR APPROVAL: <i>Matthew Sanchez</i> 4/11/08 DESIGN ENGINEER DATE NOBLESVILLE INDIANA	DESIGNED: MSL CHECKED: B.Z.	DRAWN: NSM CHECKED: MSL	PLAN AND PROFILE LINE "A" HORIZONTAL SCALE 1" = 20' VERTICAL SCALE 1" = 10' SURVEY BOOK 341 CONTRACT N/A	FILE 4596 DESIGNATION N/A SHEET 44 OF 155 PROJECT N/A
	GREGORY M. QUEBE REGISTERED LAND SURVEYOR No. 28560619 STATE OF INDIANA As built 2/5/09		HUTTON & LAMBERT REGISTERED PROFESSIONAL ENGINEERS No. PEN032008 STATE OF INDIANA	

This copy is from the Digital Archive of the Hamilton County Surveyor's Office, Noblesville, In 46060

S. NO. 4596.0701

STRUCTURE DATA

STRUCTURE NUMBER	LOCATION			SIZE	PIPE TYPE	MANHOLE, INLET CATCH BASIN OR SPECIALTY STRUCTURE	LENGTH	SKEW	FLOW LINE			SERVICE LIFE	SITE DESIGNATION	pH	BACKFILL METHOD	STRUCTURE BACKFILL	REVEALMENT RIPRAP	CONCRETE CLASS "A" FOR STRUCTURES	PIPE END SECTION	GEOTEXTILE	GRATED BOX END SECTION		SAFETY METAL END SECTION		RIM ELEVATION	CONNECT TO STRUCTURE	REMARKS								
	STATION	LEFT	RIGHT						CROSS	FEET	FEET										ELEV.	ELEV.	YEAR	CYS.				TONS	CYS.	EA.	SYS.	TYPE	EA.	SLOPE	EA.
LINE "A" (Cont.)																																			
44	39+68.00		X		15	Inlet Type B	15.0		1.1	815.60	815.45	75	N/A	7.0	1	2.2									819.45	45									
45	39+68.00, 43' Rt.		X		24	Manhole Type C	89.0		1.5	814.70	814.42	75	N/A	7.0	1	52.0									819.80	43									
46	39+92.00	X			15	Inlet Type B	43.0		1.5	815.90	815.60	75	N/A	7.0	1	14.0									819.51	44									
47	40+13.00		X		15	Inlet Type B	43.0		1.5	815.27	815.06	75	N/A	7.0	1	14.0									818.78	45									
48	40+77.00		X		15	Inlet Type B	63.0		1.2	805.56	815.22	75	N/A	7.0	1	18.0									819.37	47									
LINE "B" & "PR-1"																																			
100	50+45.00, 32' Rt.		X		36	Manhole Type J	71.0		4.5	811.51	811.41	75	N/A	7.0	1	115.0									819.93	103									
100A	50+75.00, 24' Lt.	X			36	Manhole Type J	155.0		7.5	807.12	806.85	75	N/A	7.0	1	388.0									819.38	Exist.									
101	51+20.00	X			15	Inlet Type B	36.0		1.5	815.00	814.82	75	N/A	7.0	1	12.0									818.72	102									
102	51+20.00		X		15	Inlet Type B	5.0		1.5	814.80	814.74	75	N/A	7.0	1	1.7									818.67	103									
103	51+20.00, 27' Rt.		X		36	Manhole Type J	95.0		3.0	811.44	811.28	75	N/A	7.0	1	116.0									819.28	106									
104	52+20.00	X			15	Inlet Type B	36.0		1.2	816.10	815.92	75	N/A	7.0	1	10.0									820.19	105									
105	52+20.00		X		15	Inlet Type B	5.0		2.0	815.90	815.87	75	N/A	7.0	1	2.0									819.83	106									
106	52+20.00, 27' Rt.		X		36	Manhole Type J	121.0		3.8	811.29	811.17	75	N/A	7.0	1	174.0									820.47	108									
107	53+05.00, 27' Lt.		X		36	Manhole Type J	226.0		7.5	807.80	807.42	75	N/A	7.0	1	565.0									822.84	100A									
108A	53+75.00, 25' Rt.	X			36	Manhole Type J	5.0		6.5	811.77	811.76	75	N/A	7.0	1	10.9									823.13										
108	53+81.00, 33' Rt.		X		36	Storm Water Quality Structure	65.0		7.0	811.00	811.00	75	N/A	7.0	1	151.0									823.52	OUT									
109	54+00.00, 27' Lt.		X		36	Manhole Type J	99.0		10.5	808.07	807.80	75	N/A	7.0	1	333.0									824.92	107									
110	54+75.00		X		15	Inlet Type B	5.0		1.7	820.60	820.51	75	N/A	7.0	1	1.8									824.40	111									
111	54+75.00, 27' Rt.		X		15	Manhole Type C	109.0		3.1	818.99	818.61	75	N/A	7.0	1	61.0									825.62	108									
112	55+00.00, 27' Lt.		X		36	Manhole Type J	104.0		11.8	808.35	808.07	75	N/A	7.0	1	393.0									826.86	107									
113	55+88.00, 28' Lt.	X			36	Manhole Type J	91.0		11.8	809.74	809.44	75	N/A	7.0	1	343.0									828.55	112									
113A	58+03.00, 28' Lt.		X		36	Manhole Type J	210.0		12.0	810.56	809.74	75	N/A	7.0	1	806.0									829.30	113									
114	59+75.00	X			15	Inlet Type B	36.0		1.8	822.80	822.58	75	N/A	7.0	1	13.0									826.99	116									
115	59+75.00, 27' Rt.		X		18	Manhole Type C	66.0		2.0	820.34	819.97	75	N/A	7.0	1	59.0									828.67	116									
116	60+40.00, 25' Rt.		X		30	Manhole Type J	5.0		4.5	816.84	816.80	75	N/A	7.0	1	5.8									828.23	118									
117	61+00.00	X			15	Inlet Type B	45.0		1.9	821.90	821.69	75	N/A	7.0	1	17.0									825.69	117A									
117A	61+00.00, 29' Rt.		X		30	Manhole Type J	61.0		3.8	816.95	816.81	75	N/A	7.0	1	70.8									825.69	116									
118	60+40.00, 35.6' Rt.		X		30	Storm Water Quality Structure	45.0		4.5	816.70	816.62	75	N/A	7.0	1	52.0									828.15	OUT									
119	62+20.00	X			15	Inlet Type B	45.0		1.8	821.30	821.08	75	N/A	7.0	1	17.0									825.12	120									
120	62+20.00, 28' Rt.		X		24	Manhole Type C	126.0		3.0	817.25	816.95	75	N/A	7.0	1	95.0									827.21	118									
121	64+53.00	X			15	Inlet Type B	36.0		1.2	823.50	823.32	75	N/A	7.0	1	10.0									827.38	122									
122	64+53.00		X		15	Inlet Type B	5.0		1.2	823.30	823.24	75	N/A	7.0	1	1.4									827.33	123									
123	64+53.00, 27' Rt.		X		24	Manhole Type C	234.0		4.0	817.83	817.25	75	N/A	7.0	1	222.0									828.01	120									
124	67+40.00	X			15	Inlet Type B	36.0		1.2	827.00	826.82	75	N/A	7.0	1	10.0									830.89	125									
125	67+40.00		X		15	Inlet Type B	5.0		1.8	826.80	826.74	75	N/A	7.0	1	1.9									830.92	126									
126	67+40.00, 27' Rt.		X		24	Manhole Type C	283.0		6.0	819.70	817.83	75	N/A	7.0	1	381.0									831.69	123									

This information was gathered for input into the Hamilton County Geographic Information System (GIS). This document is considered an official record of the GIS.
 Entry Date: 9/27/08
 Entered By: SLM

As Built
 2/5/09



RECOMMENDED FOR APPROVAL: *Matthew Jankovic* 4/11/08
 DESIGN ENGINEER DATE
 DESIGNED: MSL DRAWN: NSM
 CHECKED: B.Z. CHECKED: MSL

STRUCTURE DATA TABLE
 NOBLESVILLE INDIANA
 Headquarters: 8450 WESTFIELD BLVD., SUITE 300 INDIANAPOLIS, IN 46240-8302 TEL 317-713-4615 FAX 317-713-4616 www.BFSeng.com
 Branch Locations: BLUFFTON, JEFFERSONVILLE, MERRILLVILLE, PLAINFIELD

HORIZONTAL SCALE AS NOTED	FILE 4596
VERTICAL SCALE AS NOTED	DESIGNATION N/A
SURVEY BOOK 341	SHEET 96 OF 155
CONTRACT N/A	PROJECT N/A

G:\14596\AUTOCAD\ROAD\14596R01.dwg Nathan Messer Plot: 6/16/2008 11:09 AM Save: 6/16/2008 11:09 AM

BFS No. 4596.0701